



**FITTING INSTRUCTIONS FOR EH0101 EXHAUST HANGER
TO FIT HONDA CBR1000RR-R & SP 2020-**



This kit contains the items pictured and labelled over page.

Some parts may be shown for clarity of instructions only.

Do not proceed until you are sure all parts are present.

Please read all instructions before proceeding.

**IF IN ANY DOUBT WHEN FITTING OUR PRODUCTS, CONSULT ONE OF OUR DEALERS
OR HAVE FITTED BY A QUALIFIED TECHNICIAN.**

Please note that the way the kit is packed does not necessarily represent the way of mounting to the bike.

In the event of rubber washers being used to hold components onto bolts, these rubber washers can be thrown away.

DIGITAL COPIES OF THESE INSTRUCTIONS ARE AVAILABLE FROM

WWW.RG-RACING.COM

R&G

Unit 1, Shelley's Lane, East Worldham, Alton, Hampshire, GU34 3AQ

Tel: +44 (0)1420 89007 Fax: +44 (0)1420 87301 www.rg-racing.com Email: info@rg-racing.com



<u>TOOLS REQUIRED</u>	<u>GENERAL TORQUE SETTINGS</u>
<ul style="list-style-type: none"> - Set of metric Hex keys to include 5, 6 & 8mm. - 12mm socket and wrench. - Spanner set to include 13mm. 	<p>M4 BOLT = 8Nm M5 BOLT = 12Nm M6 BOLT = 15Nm M8 BOLT = 20Nm M10 BOLT = 40Nm M12 BOLT = 40Nm</p>

LEGEND

ITEM No.	DESCRIPTION	QTY
ITEM 1	HB0101 HANGER BRACKET	1
ITEM 2	M8 WASHER	4
ITEM 3	M8 x 1.25 x 20MM CAP HEAD BOLT	2
ITEM 4	M8 x 1.25 x 25MM BUTTON HEAD BOLT	1
ITEM 5	M8 NYLOC NUT	1

R&G

Unit 1, Shelley's Lane, East Worldham, Alton, Hampshire, GU34 3AQ

Tel: +44 (0)1420 89007 Fax: +44 (0)1420 87301 www.rg-racing.com Email: info@rg-racing.com



ASSEMBLY DIAGRAM

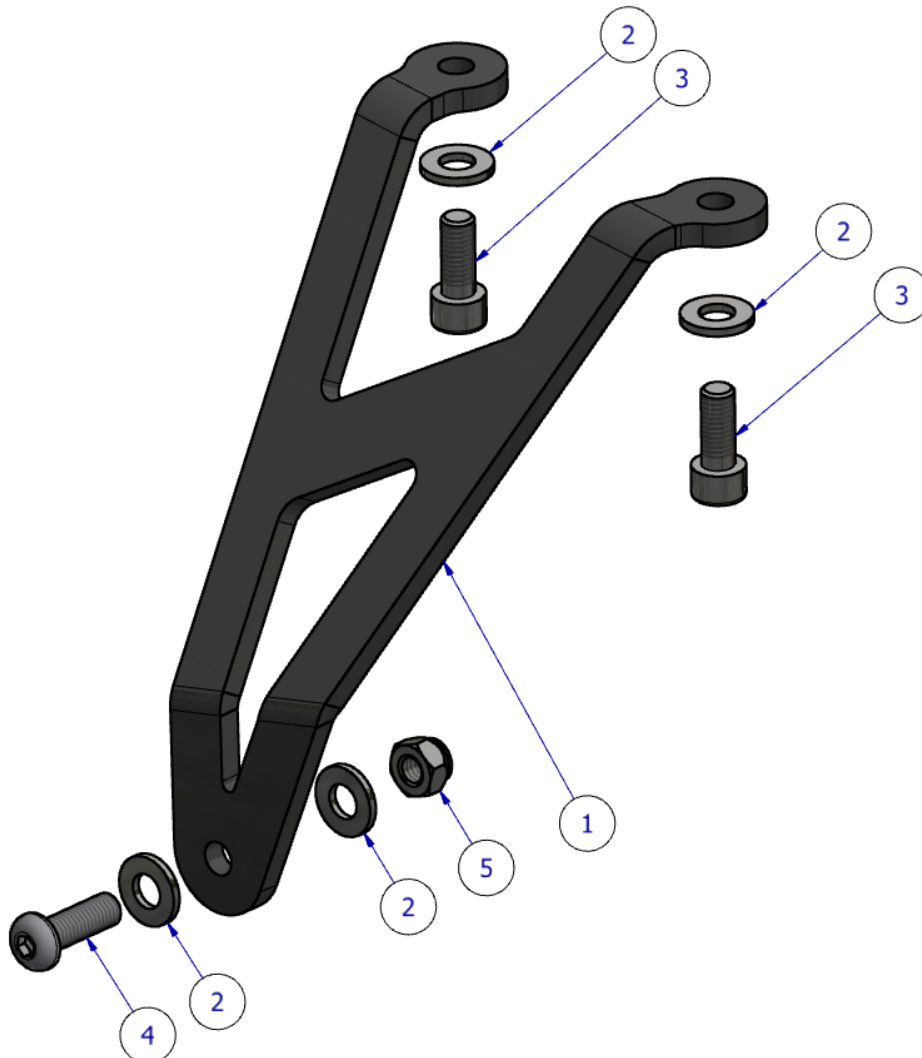

FITTING INSTRUCTIONS

- Remove the original RHS pillion footrest from the bike. To do this, first remove the OEM nut from the back of the original exhaust using a 12mm spanner and 8mm Hex key to hold the bolt.
- Remove the OEM bolt to disconnect the exhaust can from the hanger. Ensure the exhaust does not drop or change position during throughout this fitting process.
- Using a 12mm socket, remove the 2 upper bolts connecting the pillion foot peg hanger to the bike and remove carefully.
- Place one M8 washer (ITEM 2) over each of the shorter 20mm bolts (ITEM 3).
- Thread these bolts into the upper holes of the R&G Exhaust hanger (HB0101 – ITEM 1) as

R&G

Unit 1, Shelley's Lane, East Worldham, Alton, Hampshire, GU34 3AQ

Tel: +44 (0)1420 89007 Fax: +44 (0)1420 87301 www.rg-racing.com Email: info@rg-racing.com



shown in the **assembly diagram**.

- Offer the exhaust hanger into position on the bike affix the two bolts into the corresponding threaded holes on the frame left by the foot peg hanger.
- Ensure the exhaust hanger lines up correctly with the exhaust and tighten the bolts to the recommended torque using a 6mm Hex key.
- Place one M8 Washer (ITEM 2) over the M8 x 25mm button head bolt (ITEM 4).
- Place the bolt through the exhaust hanger bracket hole and exhaust mount hole.
- Place the remaining M8 washer (ITEM 2) over the thread protruding from the exhaust followed by the Nyloc nut (ITEM 5) as shown in the **assembly diagram**.
- Tighten the nut using a 13mm spanner and 5mm Hex key, ensuring the exhaust is securely held in place.

Please note that it is your responsibility to ensure that no part of the exhaust hanger or exhaust assembly fouls or comes into contact with other parts of the machine. Do not ride the motorcycle until this aspect has been verified and you have compressed the rear suspension (if appropriate to the design of the motorcycle) to test this thoroughly.

- After riding the bike, check the tightness of the bolts regularly (e.g. when cleaning the bike).

ISSUE 1 10/09/2020 (DM)

CONSUMER NOTICE

The catalogue description and any exhibition of samples are only broad indications of the Products and R&G may make design changes which do not diminish their performance or visual appeal and supplying them in such state shall conform to the order. The Buyer acknowledges no representation or warranty (other than as to title) has been given or will apply to the Products other than those in R&G's order or confirmation and the Buyer confirms it has chosen the Products as being of merchantable quality and suitable for its particular purposes. Where R&G fits the Products or undertakes other services it shall exercise reasonable skill and care and rectify any fault free of charge unless the workmanship has been disturbed. The Buyer is responsible for ensuring that the warranty on the motorcycle is not affected by the fitting of the Products. On return of any defective Products R&G shall at its option either supply a replacement or refund the purchase money but shall not be liable if the Products have been modified or used or maintained otherwise than in accordance with R&G's or manufacturer's instructions and good engineering practice or if the defect arises from accident or neglect. Other than identified above and subject to R&G not limiting its liability for causing death and personal injury, it shall not be liable for indirect or consequential loss and otherwise its liability shall be limited to the amounts paid by the Buyer for the Products or the fitting or service concerned. These terms do not affect the Buyer's statutory rights.

R&G RACING RETURNS POLICY (NON-FAULTY GOODS)

Returns must be pre-authorized (if not pre-authorized the return will be rejected). Goods may only be returned direct to us if they were purchased direct from us (customer must prove if necessary). Otherwise to be returned to original vendor. Goods must be in re-sellable condition, in the opinion of R&G Racing. All returns are subject to a 25% restocking and handling fee (25% of the gross value exc. P&P – at the prevailing price at time of purchase). The customer must pay any and all carriage charges. No returns of discontinued products, unless within 14 days of purchase. This policy does not affect your statutory rights and does not refer to faulty goods.

R&G

Unit 1, Shelley's Lane, East Worldham, Alton, Hampshire, GU34 3AQ

Tel: +44 (0)1420 89007 Fax: +44 (0)1420 87301 www.rg-racing.com Email: info@rg-racing.com



**NOTICE DE MONTAGE EH0101 SUPPORT D'ÉCHAPPEMENT
POUR HONDA CBR1000RR-R & SP 2020-**



CE KIT CONTIENT LES ARTICLES ILLUSTRÉS ET ÉTIQUETES SUR LA PAGE.

CERTAINES PARTIES PEUVENT ÊTRE PRÉSENTES UNIQUEMENT POUR LA CLARTÉ DES INSTRUCTIONS.

NE PAS PROCÉDER AU MONTAGE TANT QUE VOUS N'ÊTES PAS SÛR QUE TOUTES LES PIÈCES SOIENT PRÉSENTES.

VEUILLEZ LIRE TOUTES LES INSTRUCTIONS AVANT DE CONTINUER.

EN CAS DE DOUTE LORS DU MONTAGE DE NOS PRODUITS, CONSULTEZ UN DE NOS REVENDEURS OU FAITES APPEL À UN TECHNICIEN QUALIFIÉ.

VEUILLEZ NOTER QUE LA FAÇON DONT LE KIT EST EMBALLÉ NE REPRÉSENTE PAS NECESSAIREMENT LA MANIÈRE DE LE MONTER SUR LA MOTO.

SI DES RONDELLES EN CAOUTCHOUC SONT UTILISÉES POUR MAINTENIR LES COMPOSANTS SUR LES BOULONS, ELLES PEUVENT ÊTRE JETÉES.

R&G

Unit 1, Shelley's Lane, East Worldham, Alton, Hampshire, GU34 3AQ

Tel: +44 (0)1420 89007 Fax: +44 (0)1420 87301 www.rg-racing.com Email: info@rg-racing.com



NOTICE DISPONIBLE AU TELECHARGEMENT SUR : WWW.RG-RACING.COM

<u>OUTILS REQUIS</u>	<u>VALEURS DE SERRAGE RECOMMANDÉES</u>
- Clés hexagonales 5, 6 & 8mm.	M4 BOULON = 8Nm
- Clé à cliquet + douille 12mm	M5 BOULON = 12Nm
- Clé à molette 13mm.	M6 BOULON = 15Nm
	M8 BOULON = 20Nm
	M10 BOULON = 40Nm
	M12 BOULON = 40Nm

LÉGENDE

ARTICLE No.	DESCRIPTION	QTÉ
ARTICLE 1	HB0101 SUPPORT D'ÉCHAPPEMENT	1
ARTICLE 2	M8 RONDELLE	4
ARTICLE 3	M8 x 1.25 x 20MM BOULON	2
ARTICLE 4	M8 x 1.25 x 25MM BOULON	1
ARTICLE 5	M8 ÉCROU	1

Photo A

R&G

Unit 1, Shelley's Lane, East Worldham, Alton, Hampshire, GU34 3AQ

Tel: +44 (0)1420 89007 Fax: +44 (0)1420 87301 www.rg-racing.com Email: info@rg-racing.com



SCHÉMA D'ENSEMBLE

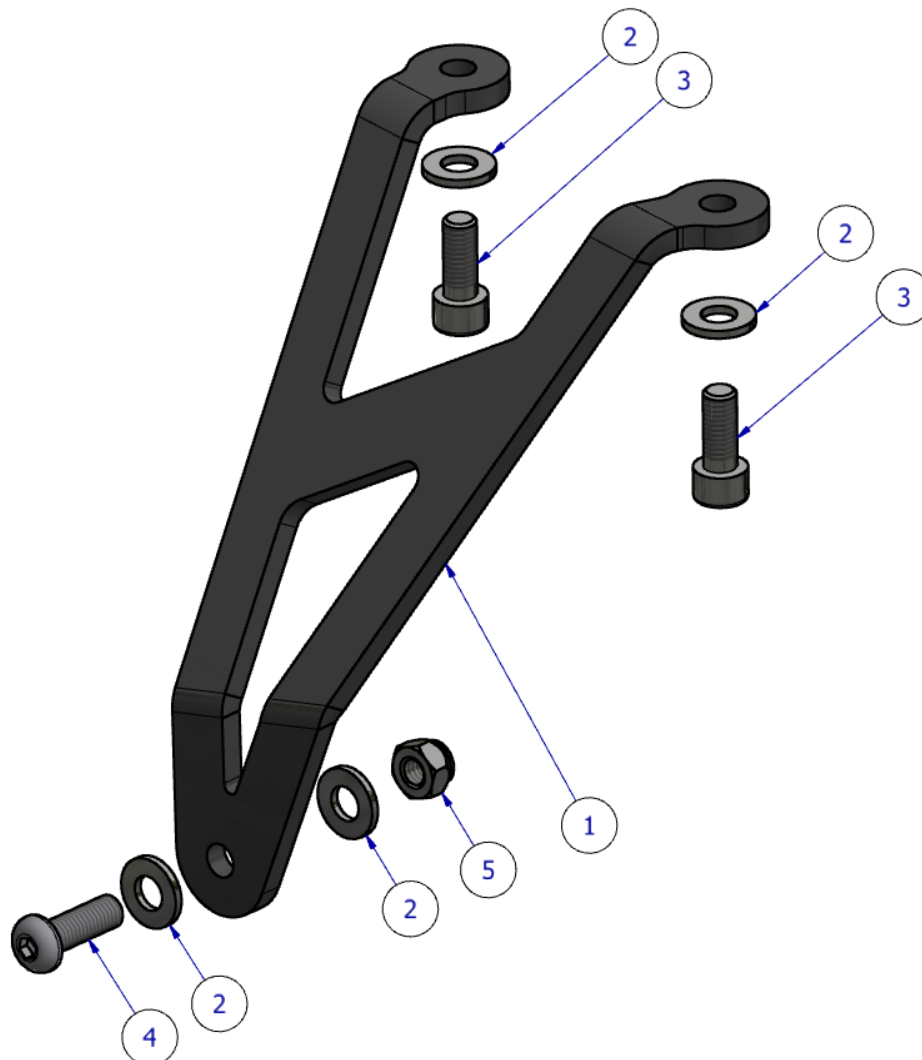

NOTICE DE MONTAGE

- Retirez le repose-pied passager côté droit d'origine de la moto. Pour ce faire, retirez d'abord l'écrou d'origine à l'arrière de l'échappement d'origine à l'aide d'une clé de 12 mm et d'une clé hexagonale de 8 mm pour maintenir le boulon.
- Retirez le boulon d'origine pour déconnecter le pot d'échappement du support. Assurez-vous que l'échappement ne baisse pas ou ne change pas de position pendant tout ce processus de montage.
- À l'aide d'une douille de 12 mm, retirez les 2 boulons supérieurs reliant le support du repose-pied du passager à la moto puis retirez-les avec précaution.
- Placer une rondelle M8 (ARTICLE 2) sur chacun des boulons les plus courts de 20 mm (ARTICLE

R&G

Unit 1, Shelley's Lane, East Worldham, Alton, Hampshire, GU34 3AQ
 Tel: +44 (0)1420 89007 Fax: +44 (0)1420 87301 www.rg-racing.com Email: info@rg-racing.com



3).

- Vissez ces boulons dans les trous supérieurs du support d'échappement R&G (HB0101 - ARTICLE 1) comme indiqué sur le schéma de montage.
- Présentez le support d'échappement en place sur la moto et fixez les deux boulons dans les trous filetés laissés par le support repose pieds sur le cadre à gauche.
- Assurez-vous que le support d'échappement s'aligne correctement avec l'échappement et serrez les boulons au couple recommandé à l'aide d'une clé hexagonale de 6 mm.
- Placer une rondelle M8 (ARTICLE 2) sur le boulon à tête ronde M8 x 25 mm (ARTICLE 4).
- Placez le boulon à travers le trou du support d'échappement et la fente du support d'échappement.
- Placer la rondelle M8 restante (ARTICLE 2) sur le filetage dépassant de l'échappement suivi de l'écrou (ARTICLE 5) comme indiqué sur le schéma de montage.
- Serrez l'écrou à l'aide d'une clé de 13 mm et d'une clé Allen de 5 mm, en veillant à ce que l'échappement soit solidement maintenu en place.

Veillez noter qu'il est de votre responsabilité de vous assurer qu'aucune partie du support d'échappement ou de l'ensemble d'échappement ne s'encrasse ou ne puisse entrer en contact avec d'autres parties de la machine. Ne conduisez pas la moto tant que cet aspect n'a pas été vérifié et que vous n'avez pas comprimé la suspension arrière (si cela convient à la conception de la moto) pour tester cela correctement.

- Après avoir conduit la moto, vérifiez régulièrement le serrage des boulons (par exemple lors du nettoyage de la moto).

ISSUE 1 10/09/2020 (DM)